

MDPC Concert Series
2014-2015

Baroque Ornaments
There's no better way to ring in the holiday season than with the warmth and joy of a Christmas concert. Featuring the glorious sounds of a soprano soloist on works by Handel, Vivaldi, and Bach.

Next Saturday, November 29
2:30 PM | MDPC Chapel

Tickets start at just \$15 and \$10 for children and students with ID: mercuryhouston.org

↑ holiday.mdpc.org

↓ missionmarket.mdpc.org

Mission Market Christmas Cards
Mission Market opens next Sunday!

Come See Us Next Weekend!

As you write your Christmas shopping list, remember the alternative gift market that makes shopping easy. Check out the insert in today's bulletin to learn how Mission Market works, and start planning for everyone on your gift list!

missionmarket.mdpc.org

↓ blessfriday.mdpc.org

BLESS FRIDAY
BLACK FRIDAY IS ABOUT SHOPPING
BLESS FRIDAY IS ABOUT SERVING

This Friday, November 28!
blessfriday.mdpc.org

Through the acts of service listed below, you can show love to wounded military men and women, feed hungry families, and share God's love at missions, group homes, or the shopping crowds at CityCentre this Advent season. Or come up with your own service project and let us know how it goes!

SERVE IN THE CITY

- Christmas decorate Vita-Living Homes
- Serve Up God's Love at Star of Hope
- Make Bless Bags for the Homeless

SERVE AT HOME

- No-Sew Pillows for Wounded Warriors
- Bag Beans & Rice for our Food Pantry
- Fill Christmas Shoeboxes for Seafarers

For details and instructions, pick up a brochure or visit BLESSFRIDAY.MDPC.ORG.

FIFTH SERVICE

Bless Friday Project

28th NOV.
at CityCentre

Please Donate:

| | |
|--------------------------|------------|
| Wisp Toothbrushes | Chapstick |
| Knee-high Athletic Socks | Hand Wipes |
| Sandwich Crackers | |

Individually-wrapped items only, please

Here's How Bless Bags Work:

- You guys donate the items at left (drop off in specially-marked bins located around the campus)
- CityCentre shoppers assemble the bags on Bless Friday, November 28
- Bags are passed out to the homeless
- All are blessed!

↑ blessfriday.mdpc.org

↓ blog.mdpc.org

How to Be a Millennial and a Christian

Brandon Gaide's latest post in this five-part series looks at the American Dream. Whereas Boomers sought stability, Millennials search for something...different.

Visit blog.mdpc.org, or read it in the mobile app (app.mdpc.org).

↓ holiday.mdpc.org

family Christmas festival
It's beginning to smell a lot like Christmas...

Join us for a musical, dinner, crafts, hot chocolate bar, Advent wreath-making, a service project, and SNOW!

It's going to be scent-sational!

Sunday, November 30
Starts at 4:00 PM with a Musical in the Chapel!
Dinner available for \$6.50/meal (\$30 max per family)

↓ women.mdpc.org

Christmas Coffee
Sponsored by MDPC Women

Celebrate the Christmas season with coffee, tea, wassail, and warm fellowship at the annual Christmas Coffee, an MDPC tradition. All women are welcome! Bring your mothers, daughters, sisters, and friends.

Tuesday, December 9
9:00-11:00 AM • MDPC Parlor

Childcare available by reservation: childcare@mdpc.org

Sunday, November 23, 2014

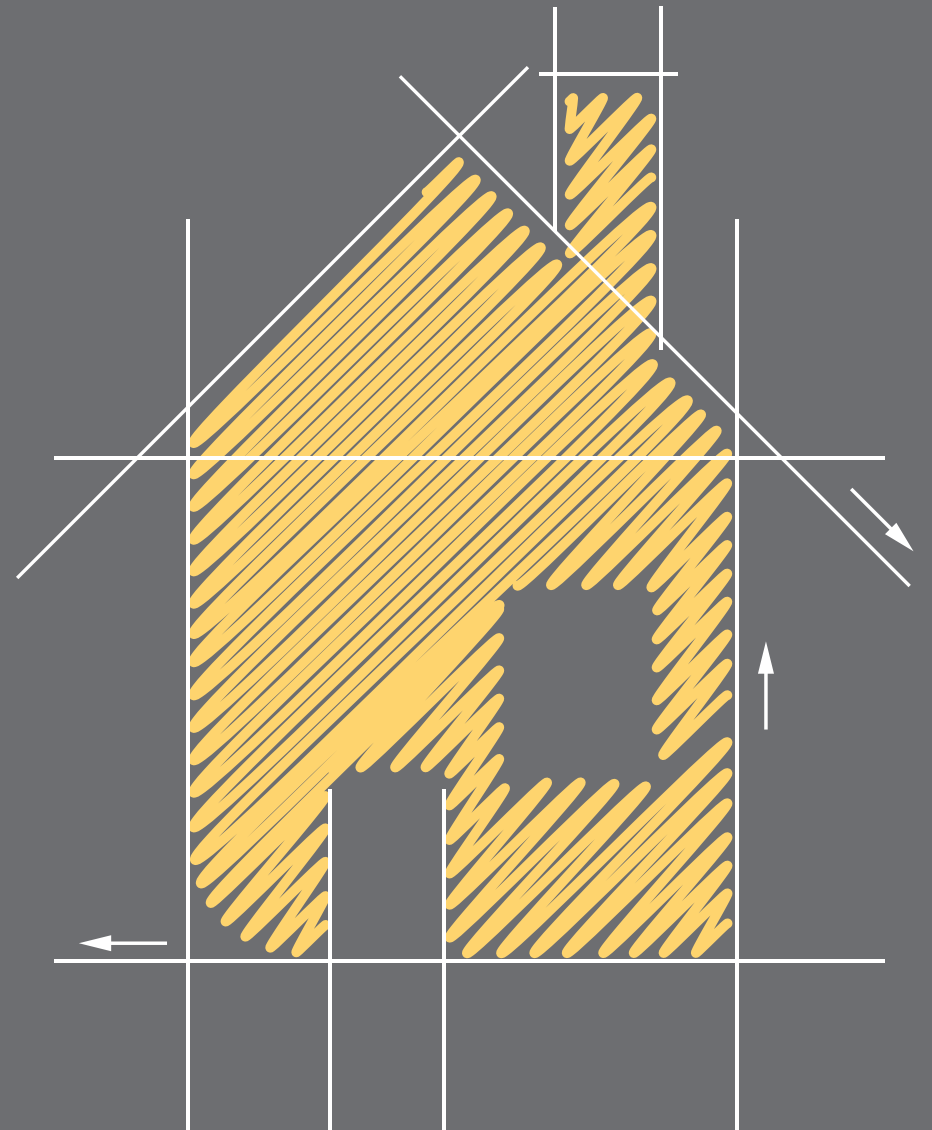

**The De-Moralizing of America
Is Demoralizing America**

Matthew 7:24-29
Howard Edington preaching

Please silence all devices, and refrain from consuming food or beverages during worship.

MDPC HIGHLIGHTS

Share Your Business Skills

Newspring’s annual Business Plan Competition begins in January. Over the past six years, over 100 MDPC members have participated as advisers to HCC students, helping them draft a business plan. It’s a great opportunity to witness to your Christian faith in a secular world. Advisers work in pairs, mentoring their contestants through the competition. For details, contact Robert Westheimer at rwestheimer1@comcast.net.

Poinsettias for the Sanctuary and Chapel

The poinsettias that adorn the chancels in December may be dedicated in honor or memory of a loved one (\$8/dedication). The names will be printed in the Christmas Eve bulletin. **Order Deadline: Friday, December 12**
Purchase online: flowers.mdpc.org

Christmas for Kids

If you signed up to sponsor a child, please return gifts to MDPC by December 1. We need volunteers to help distribute the gifts at Spring Branch Community Health Center! **Gift distribution: December 11-12 | 9:00 AM-2:00 PM**
To volunteer, visit women.mdpc.org.

The Toy Train Is Here!

Share God’s blessings with those less fortunate this Christmas. MDPC’s Mobile Unit starts spreading holiday spirit around Houston during the first week of December, bringing toys from the Toy Train to give to the children, in addition to the very affordable clothing and home items always available. Visit the Toy Train outside Children’s Ministries. **Please drop off new, unwrapped toys through December 16.**
Contact Maritza Pujols for more information: mpujols@mdpc.org or 713-490-9556

Volunteers Needed: Refugee Thanksgiving Dinner

This holiday season, let’s open our hearts and doors to those in need of blessing – refugees from all over the world who live near MDPC. We’re staging our annual Thanksgiving Dinner to share the holiday spirit and welcome them to the neighborhood. Please consider serving; we need your help with food service or as a table host. **Tuesday, November 25 | Fellowship Hall**
Sign up to serve: holiday.mdpc.org

Breathe, Pray, Listen

Learn about exemplars of the faith (St. Patrick of Ireland, St. Benedict, Hildegard of Bingen, Francis of Assisi, Ignatius of Loyola, Francis de Sales), then participate in one of the spiritual practices. MDPC Associate Pastor Kristin Huffman leads. **Wednesdays, December 3 & 10 | Noon or 6:30 PM | Summit Room**
No cost; meals are available for purchase.

Christmas Greenery

It’s the Boy Scouts’ annual Christmas greenery sale. Stop by to support MDPC’s Troop 642. **Sunday, December 7 | Between services in the Sanctuary Breezeway**

Feeling the Nudge to Start a Small Group...

...but not sure where to start? We can help! Shoot me an email to swap ideas, learn best practices for groups that work, and see how the church can be of support. *Christyn Knoop, Adult Ministries Director: cknoop@mdpc.org or 713-490-0940*

Save the Date! ParentPalooza 2015

A fun, two-day parenting fest at MDPC! Come dig deeper with other parents in breakout sessions designed to equip you to be more effective in parenting. **Friday, January 9 (6:30-8:30 PM) & Saturday, January 10 (9:00-11:30 AM) | Free!**
Register today! parenting.mdpc.org
Childcare available by reservation: childcare@mdpc.org

MDPC WORSHIP

*Please stand if able. CCLI # 182374

8:30 BLENDED SERVICE

| | | |
|---|--|-----------------|
| WELCOME | | Kristin Huffman |
| *SONGS OF PRAISE | <i>He Is Exalted</i> | Twila Paris |
| | <i>Come, Thou Fount of Every Blessing</i> | NETTLETON |
| *PRAYER OF CONFESSION AND ASSURANCE OF PARDON | | Brett Hurst |
| SONG OF PREPARATION | <i>All Hail the Power of Jesus’ Name</i> | CORONATION |
| GIFTS OF GRATITUDE | <i>Good to Me</i> | Audrey Assad |
| MESSAGE | The De-Moralizing of America Is Demoralizing America | Howard Edington |
| SONG OF RESPONSE | | |

9:45 CONTEMPORARY SERVICE

| | | |
|--|--|-----------------|
| *SONGS OF PRAISE | | |
| *PRAYER OF CONFESSION | | Brandon Gaide |
| BAPTISMS | | Howard Edington |
| Grace Alford, daughter of Andrew and Jaclyn Alford | | |
| Christopher Ryan Aycock, son of Robert and Katherine Aycock | | |
| Katherine Clew Aycock | | |
| William Eugene Filip, son of Matthew Filip and Amanda Hamelers | | |
| Piper Dianne Kleypas, daughter of Casey and Sarah Kleypas | | |
| Liam Hudson Tackett, son of Scott and Heather Tackett | | |
| GIFTS OF GRATITUDE | | Kristin Huffman |
| MESSAGE | The De-Moralizing of America Is Demoralizing America | Howard Edington |
| SONG OF RESPONSE | | |

11:15 TRADITIONAL SERVICE

| | | |
|---|--|---------------------------------------|
| PRELUDE | <i>Let Us Give Thanks</i> | arr. Sprunger |
| | Yan Shen, piano; Kathryn White, organ | |
| *CALL TO WORSHIP | | Kristin Huffman |
| *HYMN OF PRAISE | <i>Come, Ye Thankful People, Come</i> | #551; Vs. 1, 4 ST. GEORGE’S WINDSOR |
| *PRAYER OF CONFESSION AND ASSURANCE OF PARDON | | Christyn Knoop |
| *AFFIRMATION OF FAITH from the United Church of Canada | | |
| ANTHEM | <i>The Promise of Living</i> | Aaron Copland (1900-1990) |
| | Yan Shen and Kathryn White, pianists | |
| BAPTISMS | | Howard Edington |
| Claire Adelaide Rae, daughter of Sean and Corrie Rae | | |
| Avery Woodie Cole, daughter of Donald and Lauren Cole | | |
| Spears Baerecke Howell, son of Robinson and Ramsey Howell | | |
| Steele Walling Howell, son of Robinson and Ramsey Howell | | |
| OFFERTORY | <i>Now Thank We</i> | Bob Chilcott (b. 1955) |
| MESSAGE | The De-Moralizing of America Is Demoralizing America | Howard Edington |
| *HYMN OF RESPONSE | <i>O Beautiful, for Spacious Skies</i> | #564; Vs. 1 MATERNA |
| POSTLUDE | <i>Toccata from Suite Gothique</i> | L. Boellmann |

OTHER WORSHIP OPPORTUNITIES

| | | |
|-----------------|-------------------|--|
| SPANISH SERVICE | 11:15 AM Chapel | fuente.mdpc.org |
| FIFTH SERVICE | 5:00 PM Chapel | fifthservice.mdpc.org |

MDPC INFO

Coordinating Team

Mauricio Chacón | Associate Pastor for Fuente
Howard Edington | Interim Senior Pastor
Brandon Gaide | Associate Pastor for Next Gen
Ginny Glass | Communications & Media Dir.
Meliza Gómez | Contemporary Music Dir.
Luke Gordon | Youth Ministries Dir.
Charles Hausmann | Traditional Music Dir.
Kristin Huffman | Associate Pastor for Outreach
Brett Hurst | Relationships Minister
Victoria Jones | Associate Pastor for Equipping
Gena Kooken | Sr. Leadership Ministry Coord.
Rick Myers | Associate Pastor for Caring
Rachel Poysky | Children’s Ministries Dir.
Becky Riggs | Business Administrator
Dave Steane | Executive Pastor & Head of Staff
Kathryn White | Coordinating Music Dir.
Karen Winship | Human Resources Dir.

Dave Peterson | Pastor Emeritus
Gary Bowker | Pastor Emeritus

MDPC Foundation
For information, contact Business Administrator
Becky Riggs at briggs@mdpc.org or 713-953-2570.

Ministry Partners

Pray for these MDPC partners working to make a difference in the lives of others:
West Houston Community Center offers programs for people to restore purpose and productivity to their lives, learn new skills, develop healthy relationships, and experience positive growth. Their core programs include Palmer Drug Abuse Program, Alcoholics Anonymous, Family Point Resources, Young Life, and Fellowship of Memorial.
westhoustoncc.com

Westside Homeless Partnership is a two-stage housing initiative in Spring Branch ISD for homeless families with children, or families in imminent danger of becoming homeless. Through financial support and comprehensive services, clients receive the education and counseling they need to achieve self-sufficiency and permanent housing.
westsidehomeless.org

Faith Ministry serves the poorest of the poor in the colonias of Reynosa and Miguel Aleman in Mexico. They build homes, provide medical care and education, and teach about Jesus Christ. They have struggled to build homes in the last few years since violence due to the drug war has kept American teams from coming to Mexico.
faithministry.org



Praises & Prayers

Today’s Chancel Flowers are given in honor of Mildred Kemper’s 100th birthday, by Linda and John Kemper.

You Shop, Amazon Gives.

When you shop amazon.com through the MDPC link below, Amazon donates 0.5% of the price of eligible AmazonSmile purchases to MDPC and its ministries.
amazon.mdpc.org

Did You Know...

...that MDPC has a 501(c)(3) Foundation? It was founded in 1994 for the purpose of accepting outright gifts and/or gifts through your last will and testament.
Contact Becky Riggs for info: briggs@mdpc.org or 713-953-2570

| WEEKLY FINANCIAL UPDATE | | |
|-------------------------------|--|---------------|
| OPERATING INCOME | | |
| 2014 Budget | | \$ 10,550,000 |
| Expected Income to Date | | \$ 7,066,532 |
| Actual Income to Date | | \$ 6,814,523 |
| Current Income Deficit | | \$ 252,009 |



Loving God. Proclaiming Christ. Living Generously. Engaging All.
11612 Memorial Drive | Houston, Texas 77024 | mdpc.org | 713-782-1710

2014 Mission Market Order Form

| Local Ministry Partners | | | | |
|--------------------------|--|--|-----|------|
| | NAME | THEIR MISSION | NO. | AMT. |
| 1 | Amazing Place amazingplacehouston.org | Fellowship, memory care, and wellness for adults with memory loss and their families | | |
| 2 | Casa de Esperanza casahope.org | A "house of hope" for children in crisis due to abuse, neglect, or the effects of HIV/AIDS | | |
| 3 | Children's Activity Center sgnh.org | Brings the life changing message of Jesus to at-risk kids in Houston's toughest neighborhoods | | |
| 4 | Palmer Drug Abuse Program pdaphouston.org | Support for teens recovering from substance abuse; free individual and family counseling | | |
| 5 | Presbyterian Children's Homes and Services texas.pchas.org | Christ-centered care and support for children and families in need in Texas, Louisiana, and Missouri | | |
| 6 | Small Steps Nurturing Center ssnc.org | A Christian ministry of high-quality preschool education for economically at-risk students living in the First, Second, Fourth, and Fifth Wards of Houston | | |
| 7 | Urban Outreach urbanoutreachinc.org | Education for at-risk children in low-income areas, including after-school programs, Bible studies, and Christian summer camps | | |
| 8 | Vita-Living vitaliving.org | Group homes and care for children and adults with intellectual and developmental disabilities | | |
| Global Ministry Partners | | | | |
| | NAME | THEIR MISSION | NO. | AMT. |
| 9 | The Antioch Partners theantiochpartners.org | Enables those called by God to enter long-term, cross-cultural ministerial service | | |
| 10 | Berea Bible Institute Mexico institutoberea.org | Small seminary that equips young pastors to bring Christ into impoverished areas of Mexico | | |
| 11 | Evangelical Theological Seminary Egypt etsc.org/new | Prepares students to witness for Christ as their country undergoes political and cultural transitions | | |
| 12 | Faith In Practice Guatemala faithinpractice.org | Provides surgical, dental, and medical care, along with health education to the poor | | |
| 13 | Far East Broadcasting Co. Indonesia febco.org | Broadcasts Christian radio and ministers to people in Asia and the former Soviet Union | | |
| 14 | Free Wheelchair Mission freewheelchairmission.org | Provides wheelchairs to the physically disabled poor in Third World countries | | |
| 15 | Light of Hope Ethiopia pff.net | Establishes schools and equips Christian teachers to educate Muslim children in Ethiopia | | |
| 16 | Living Water International water.cc | Drills clean water wells, teaches hygiene, and shares the Gospel in developing countries | | |
| 17 | Lulwanda Children's Home Uganda ugandaorphans.org | A Christian home and school caring for abandoned children and those left orphaned by AIDS | | |
| 18 | The Micah Project Honduras micahprojecthonduras.org | A Christian home and school for former street boys and a neighborhood outreach | | |
| 19 | Nueva Vida Guatemala newlifeguatemala.com | A Christian school for special needs children unable to enter the Guatemalan public school system | | |
| TOTALS | | | | |

Order online at missionmarket.mdpc.org

ORDER FORM INSTRUCTIONS

missionmarket.mdpc.org

Using the **MISSION MARKET ORDER FORM** on the opposite side of this page, indicate the following:

1. From the **MINISTRY PARTNER** column, choose which Ministry Partner(s) you wish to support.
2. In the **NO.** column, write the number of cards you plan to gift featuring that Ministry Partner. This is the number of information cards you will receive for that Partner.
3. In the **AMT.** column, write the total amount you would like to give in support of your selected Ministry Partner(s). This may be for *any* amount over the \$1 minimum.
4. When your choices are complete, add up the vertical items in the two columns, and record in the **TOTALS** row at the bottom.
5. The **TOTAL AMT.** is what you owe. The **TOTAL NO.** is how many you will receive of each of the following:
 - (a) Christmas greeting card and envelope
 - (b) Ministry Partner information card indicating to the gift recipient which Ministry Partner you are supporting in their honor
 - (c) HOPE sticker for securing the Ministry Partner information card on the inside panel of the greeting card
6. Complete your personal information below, and bring your completed form to the Mission Market table.

Name (please print) _____

Email _____

Paid: ☐ Check # _____ Date ____/____/____

Please make checks payable to "MDPC." Write Mission Market on the memo line.

☐ Credit Card

There are a variety of designs available for your 2014 Christmas Cards.



Thank you for supporting our Ministry Partners. Your donations make a difference as we reach out to the world in Jesus' Name!



MDPC Memorial Drive Presbyterian Church | Houston, TX
Loving God. Proclaiming Christ. Living Generously. Engaging All.

The De-Moralizing of America Is Demoralizing America

Matthew 7:24-28 | Howard Edington preaching

One of the most important questions to ask when buying a home is: How solid is the construction? Most of us are familiar with the story of *The Three Little Pigs*. Each built a different kind of house. One was made of straw, and another was made of wood, and the third was made of bricks. When the nasty wolf came, he blew down the houses of straw and wood, but he could not topple the house of bricks. Solid construction is wolf-proof!

Like a home, our Christian faith must be built with solid construction. Care must be taken to ensure there is structural integrity to the Christian life and faith God seeks to build in us. Jesus, the Master-Teacher, knew this truth and challenged His disciples to build on a solid foundation in Matthew 7:24-28:

²⁴ “Therefore everyone who hears these words of Mine and puts them into practice is like a wise man who built his house on the rock. ²⁵ The rain came down, the streams rose, and the winds blew and beat against that house; yet it did not fall, because it had its foundation on the rock. ²⁶ But everyone who hears these words of Mine and does not put them into practice is like a foolish man who built his house on sand. ²⁷ The rain came down, the streams rose, and the winds blew and beat against that house, and it fell with a great crash.” ²⁸ When Jesus had finished saying these things, the crowds were amazed at His teaching.

- The first challenge Jesus gives is to *hear these words of Mine*. Is there a difference between *listening* and *hearing*? Reflect on the experience of talking to someone, only to realize that they really weren’t listening. To *hear* something as Jesus intended means to not only let the words go in your ears and into your brain, but also to let those words descend to your heart to become authoritative and directive. How have you experienced this?
- In what ways do you seek to put the words of Jesus into practice in your life? How do you handle the prickly passages where Jesus says things that you find difficult to embrace?
- Jesus offers a contrast between building on the *rock* and building on the *sand*. What things have you built that were on a sandy foundation? On a rocky foundation? What are some of the important lessons in this contrast?
- The house Jesus describes is assaulted by the forces of rain, streams, and wind. How have you experienced these forces in your Christian faith? What were the results?
- *The crowds were amazed at His teaching*. Why do you think this was true? In what ways does Jesus’ teaching amaze you?

Digging Deeper is written by Executive Pastor, Dave Steane, and further explores Dr. Edington’s weekly Scripture passage, but not necessarily his sermon message.